

Haven Parkway

(40' Wide)

Timber

North 104.00'

(54')

North 149.64'

(50')

(50')

South Lakeshore Drive

(49.5' Wide)

Tax Parcel
ISA 00057
0.320 Acre
13,934 Sq.Ft.

House Lot 58
W4652

Poured
Concrete
Foundation

Timber & Brick Retaining Wall

(56')

S0°03'42"W 106.35'

(50')

Garage Corner 0.1' E. of line

Garage Corner 0.2' E. of line

Garage

Wires

Overhead

Pipe 0.62' E.

Pipe leans NW

Lot 56

Lot 54

Lot 52

Lot 47

Tax Parcel ICA 00047A

Tax Parcel ICA 00047B

Tax Parcel ICA 00048A

Large Lot I

Ross D. Sillis

Subdivision

Plat of Survey

of

Lots 58 & 60 of Shore Haven,

a subdivision located in Government Lot 2 in the the
Northeast 1/4 of Section 18, Town 1 North, Range 17
East, Town of Linn, Walworth County, Wisconsin.

Surveyed for: **Bill Humphrey**
8652 South Tripp
Chicago, Illinois. 60652

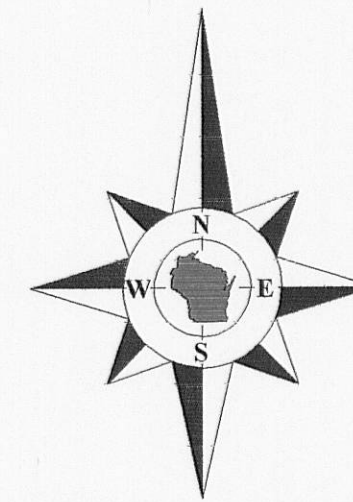

Bearings referenced to the East line of
Haven Parkway, assumed as North.

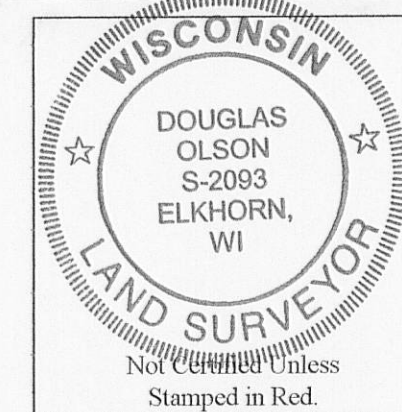

Notes:

- 1) This survey plat is not certified unless signed and sealed in red ink.
- 2) This survey is subject to Wisconsin lien laws. This Plat of Survey is the notice of intent to file lien. Lien waiver required.

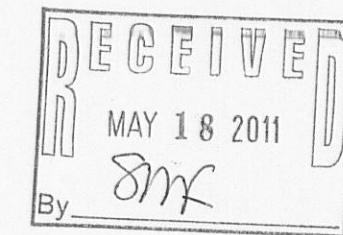

Copyright 2010 by Jensen & Olson Land Surveying, LLC.

All rights reserved. No part of this survey plat may be reproduced or transmitted in any form by any means - graphic, electronic, or mechanical, including photocopying, tracing, or information storage and retrieval systems - without permission in writing from Douglas G. Olson, Jensen & Olson Land Surveying, LLC.

I, Douglas G. Olson, Wisconsin Registered Land Surveyor, do hereby certify that this survey was performed by me, or under my direction in full compliance with the owner's/agent's instructions and Chapter A-E 7 of the Wisconsin Administrative Code "Minimum Standards for Property Surveys"; and that this map is an accurate representation thereof to the best of my knowledge and belief.

Douglas G. Olson
Wisconsin Registered Land Surveyor - 2093

Survey Date: September 28, 2010.
Revisions: No. 1 - Proposed Garage construction
No. 2 - Garage under construction

Scale in Feet
1" = 20'
0 10' 20' 40'

Jensen & Olson Land Surveying, LLC

45 South Wisconsin Street * P.O. Box 322 * Elkhorn, Wisconsin. 53121
Telephone: (262) 723-3434 * Facsimile: (262) 723-8044
Email: jensen.olson@elknet.net

Legend

- Found Iron Pipe
- Found Iron Rod
- Recorded Information
- Utility Pole
- Utility Pedestal
- Asphalt Surface
- Concrete Surface
- Gravel
- Brick Pavers or Patio Blocks

Sheet 1 of 1 Sheets
Drawing Name: Unit 1-2010075-2010075Plat.sv

Job Reference Number
2010.075

2010.075